

# FLEX SPACE FOR LEASE

## 1634 S. RESEARCH LOOP #160

**Tucson, AZ**

**LEASE RATE:** \$.75SF/Mod Gross  
+ CAM

**ZONING:** City of Tucson  
Light Industrial

**SIZE:** 2168 +/- SF

**LAND:** NA

**OFFICE:** 1800 +/-SF

**YARD:** NA

**DOORS:** 1 (10'x10')

**CEILING HT:** 18 FT

**UTILITIES:** Single Phase

**CONSTRUCTION:** Concrete

**COOLING:** HVAC

**COMMENTS:** High tech office space with small amount of warehouse. This space is located within Tucson's Eastside Research Park, located between 22nd and Golf Links off of Pantano Parkway. Owners are highly motivated! Bring all offers, nice space!

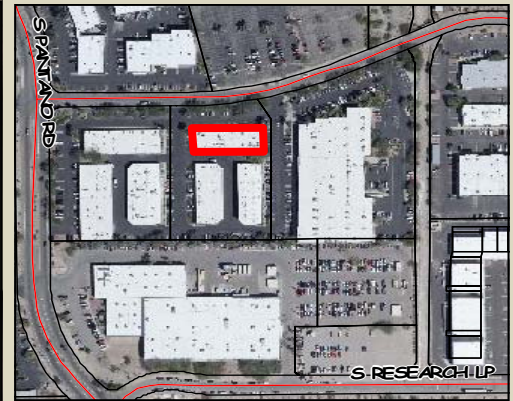

**DAVID A. GALLAHER, CCIM**  
6061 E Grant Rd.  
Suite# 119  
Tucson, AZ 85712  
**Phone:** 520.294.1610  
**Fax:** 520.290.5293  
[www.tucsonindustrialrealty.com](http://www.tucsonindustrialrealty.com)  
[dave@tucsonindustrialrealty.com](mailto:dave@tucsonindustrialrealty.com)



The information herein was obtained from third parties, and it has not been independently verified by the Real Estate Brokers. Buyer/Tenants should have the experts of their choice inspect the property and verify all information including the availability. Linear and area measurements are approximate, often are inaccurate and should be confirmed by the licensed surveyor of the buyers tenants choice. Real Estate Brokers are not qualified to act as or select experts to legal, tax, environmental, building construction, soils drainage or other such matters.

